

- NOTE:**
1. ALL DIMENSIONS IN MM [INCH]
 2. GENERAL TOLERANCE: X.X=±0.4
X.XX=±0.25
 3. TERMINAL NUMBERS FOR REF ONLY
 4. CIRCUIT: SPST OFF-ON (LATCHING)
 - ▲ 5. CONTACT MATERIAL: Gold over SILVER
 6. RATING: 100mA @ 24 VDC
 7. ELECTRIC LIFE: 200,000 CYCLES AT FULL LOAD
 8. CONTACT RESISTANCE: 100 milli-OHM max. (INITIAL)
 9. INSULATION RESISTANCE: 1,000 MEGA-OHM min. @ 500VDC.
 10. DIELECTRIC STRENGTH: 1,000 VAC rms.
 11. OPERATING FORCE: 350 gf ±150 gf
 12. OPERATING TEMPERATURE: -30°C TO +85°C.
 13. CONTACT BOUNCE: 10ms MAX.
 - ▲ 14. TRAVEL: 2.5mm ±0.25mm
 15. PANEL THICKNESS RANGE: 1.5 - 4.0 mm.
 16. ▲ DENOTES CRITICAL PARAMETER.
 17. 2011/65/EU (ROHS) COMPLIANT
 18. MAX MOUNTING TORQUE: 1.5 Nm APPLIED TO THE NUT
 - ▲ 19. HARDWARE INCLUDED:
 1. T081101 LOCK WASHER (1)
 2. T081102 HEX NUT (1)
 3. T081103 O-RING (1)
 20. SEAL RATING: IP67 AT THE FRONT PANEL

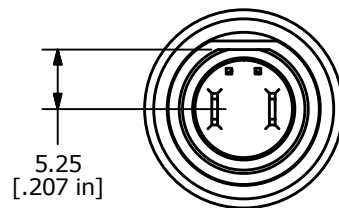

B	22456	UPDATED OPER. FORCE FROM 560 TO 350	8/17/16	MJR
A	22155	NEW RELEASE	2/17/16	MW
REV	PCR NO	DESCRIPTION	DATE	BY

E-SWITCH®				
TITLE RP8200B2M1CEBLKGRYNIL				
SCALE	DATE	DR	DWG	REV
3:2	2/17/2016	MW	ST082009	B

THE INFORMATION CONTAINED IN THIS DOCUMENT IS PROPRIETARY TO E-SWITCH AND IS NOT TO BE COPIED OR TRANSFERRED